



DRAWING NUMBER
SPS-B-95846

ISSUE DATE
8/01/01

REVISION

①

9/11/01

②

11/29/01

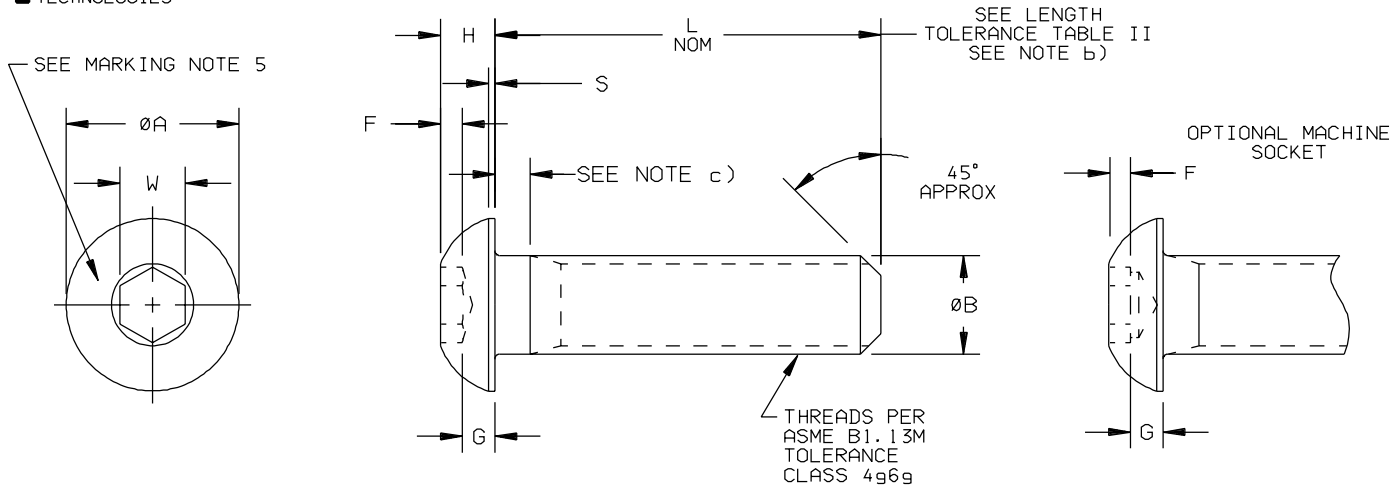

TABLE I

NOM. DIA.	THREADS	ØA		ØB NOM	F MIN	G MIN	H		L NOM MAX STND LENGTH	S REF	W NOM	TENSILE STRENGTH kN MIN (a)
		MAX	MIN				MAX	MIN				
M3	MJ3X0.5	5.70	5.40	3.0	1.04	0.20	1.65	1.43	12	0.38	2.0	1.9
M4	MJ4X0.7	7.60	7.24	4.0	1.30	0.30	2.20	1.95	20	0.38	2.5	3.4
M5	MJ5X0.8	9.50	9.14	5.0	1.56	0.38	2.75	2.50	30	0.50	3.0	5.5
M6	MJ6X1	10.50	10.07	6.0	2.08	0.74	3.30	3.00	30	0.80	4.0	7.7
M8	MJ8X1.25	14.00	13.57	8.0	2.60	1.05	4.40	4.05	40	0.80	5.0	14.1
M10	MJ10X1.5	17.50	17.07	10.0	3.12	1.45	5.50	5.20	40	0.80	6.0	22.3
M12	MJ12X1.75	21.00	20.48	12.0	4.16	1.63	6.60	6.24	60	0.80	8.0	32.4
M16	MJ16X2	28.00	27.48	16.0	5.20	2.25	8.80	8.44	60	1.50	10.0	60.3

a). ULTIMATE TENSILE STRENGTH IS CALCULATED USING TENSILE STRESS AREA PER APPENDIX B OF ASME B1.13M AND 385MPa MINIMUM STRESS LEVEL

b). THE STANDARD LENGTHS SHALL BE AS FOLLOWS: 3, 4, 5, 6, 8, 10, 12, 16, 20, 25, 30, 35, 40, 45, 50, 55, AND 60. THE LONGEST STANDARD NOMINAL LENGTHS FOR THE RESPECTIVE SCREW SIZES ARE LISTED IN TABLE I.

c). SCREWS OF NOMINAL LENGTHS EQUAL TO OR SHORTER THAN THE LONGEST STANDARD LENGTHS LISTED UNDER COLUMN L IN TABLE I SHALL BE THREADED FULL LENGTH. THE DISTANCE MEASURED, PARALLEL TO THE AXIS OF THE SCREW, FROM THE UNDERSIDE OF THE HEAD TO THE FACE OF A NONCOUNTERBORED OR NONCOUNTERSUNK STANDARD GO THREAD RING GAGE ASSEMBLED BY HAND AS FAR AS THE THREAD WILL PERMIT, SHALL NOT EXCEED TWO PITCHES (THREADS). FOR LONGER SCREWS, THE LENGTH OF COMPLETE (FULL FORM) THREAD SHALL, AT THE OPTION OF THE MANUFACTURER, BE BETWEEN A MINIMUM LIMIT EQUAL TO TWICE THE BASIC SCREW DIAMETER PLUS 12.0 MM AND A MAXIMUM LIMIT OF TO WITHIN TWO PITCHES (THREADS) OF THE HEAD.

TABLE II

LENGTH TOLERANCE, mm	
NOMINAL SCREW LENGTH	TOLERANCE
UP TO 16, INCL	±0.3
OVER 16 TO 60, INCL	±0.5

1. MATERIAL: AUSTENITIC STAINLESS STEEL PER CHEMISTRY OF ASTM F879M.
2. HEAT TREATMENT: 550MPa MINIMUM ULTIMATE TENSILE STRENGTH.
3. FINISH: SEE NOTE 6.
4. DIMENSIONS AND GEOMETRIC TOLERANCING PER ASME B18.3.4M - INCLUDING MANUFACTURING NOTES NOT LISTED IN THIS DRAWING.
5. MARK "S" OR "SPS" AS APPLICABLE.
6. PART NUMBER: 95846()-()-()

- FINISH: C = CADMIUM PLATE PER QQ-P-416, TYPE I, CLASS 3.
 D = CADMIUM PLATE PER QQ-P-416, TYPE II, CLASS 3.
 H = CADMIUM PLATE PER QQ-P-416, TYPE I, CLASS 2.
 J = CADMIUM PLATE PER QQ-P-416, TYPE II, CLASS 2. (YELLOW CHROMATE)
 M = CADMIUM PLATE PER QQ-P-416, TYPE II, CLASS 2. (OLIVE DRAB)
 S = SILVER PLATE PER AMS 2410.
 U = ZINC PLATE PER ASTM B633 TYPE III SCI.
 Z = ZINC PLATE PER ASTM B633 TYPE II SCI.
 NO LETTER = PASSIVATE PER ASTM A967 OR EQUIVALENT.

- LENGTH IN MILLIMETERS
 DIAMETER PER TABULATION
 LOCKING FEATURE - NO LETTER = NO LOCKING FEATURE
 E = TYPE P (PATCH) PER MIL-DTL-18240
 K = TYPE N (PELLET) PER MIL-DTL-18240.

7. DIMENSIONS ARE IN MILLIMETERS.

INFORMATION ON THIS DOCUMENT IS A TRADE SECRET, PROPRIETARY, AND SHALL NOT BE USED OR REPRODUCED IN WHOLE OR IN PART WITHOUT WRITTEN AUTHORIZATION OF SPS TECHNOLOGIES.

TOLERANCES ±0.25 AND ±2* SURFACE ROUGHNESS 3.2 UNLESS OTHERWISE NOTED	THIS PRODUCT DRAWING IS DRAFTED IN ACCORDANCE WITH ASME Y14.5M DATE: 8/01/01	 FSCM NO. 56878 CUSTODIAN: JENKINTOWN, PA.	STANDARDS AND SPECIFICATIONS ASTM F879M EXCEPT AS NOTED
DRAWN BY: STEVE FOSTER APPROVED: L KLINE APPROVED: S FOSTER	DATE: 11/30/01		TITLE SCREW, BUTTON HEAD CAP, HEXAGON RECESS, AUSTENITIC STAINLESS STEEL, 385MPa Ft _u